

- Z23 ■ These assemblies must comply with workmanship standards IPC-A-610 Class 2, unless otherwise specified.
- Z22 ■ These assemblies must be clean and free from flux and all contaminants. Use of no clean flux is not acceptable.
- Z21 ■ These assemblies are ESD sensitive, ESD precautions shall be observed.

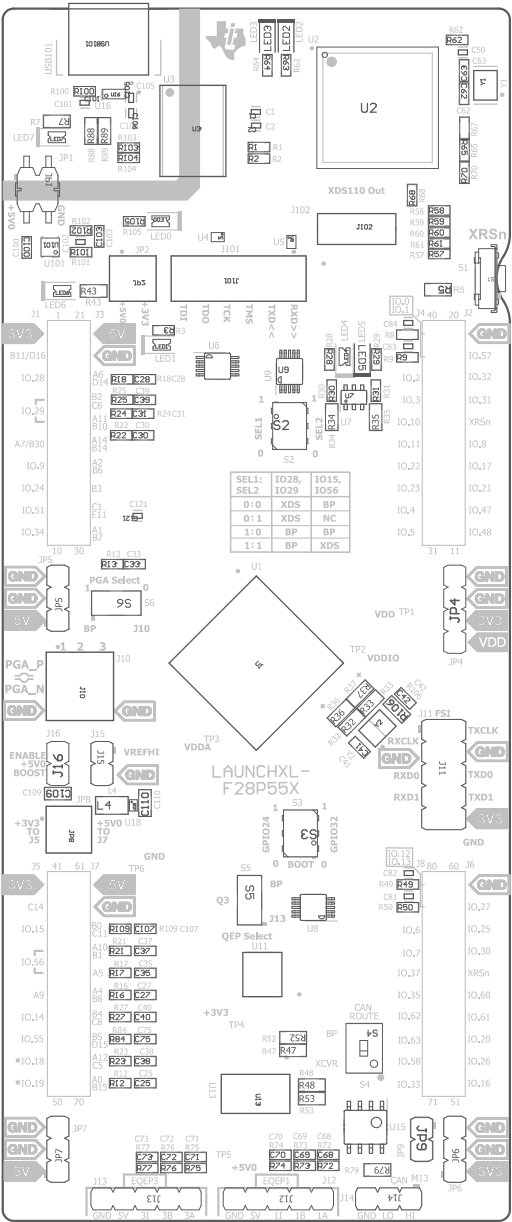

COMPONENTS MARKED 'DNP' SHOULD NOT BE POPULATED.
ASSEMBLY VARIANT: [No Variations]

PCB VIEWED FROM TOP SIDE	BOARD #:	MCU133	REV:	A	SUN REV:	Unknown revision
M50A Assembly Top	TID #:	N/A				
PLOT NAME = Top Assembly Drawing	GENERATED	: 4/5/2024	7:10:15 PM	TEXAS INSTRUMENTS		

