

NOTES: UNLESS OTHERWISE SPECIFIED:

© COPYRIGHT 2016 TEXAS INSTRUMENTS
UNPUBLISHED, ALL RIGHTS RESERVED

REVISIONS			
REV	DESCRIPTION	DATE	BY
A	INITIAL RELEASE	1/25/2017	SS
B	UPDATE FOR FAN MOUNT CHANGE	2/3/2017	SS
C	UPDATED PART DESCRIPTIONS	7/21/2017	SS
D	ADDED ITEM 14, ITEM 8 QTY REDUCED TO 1	8/25/2017	SS

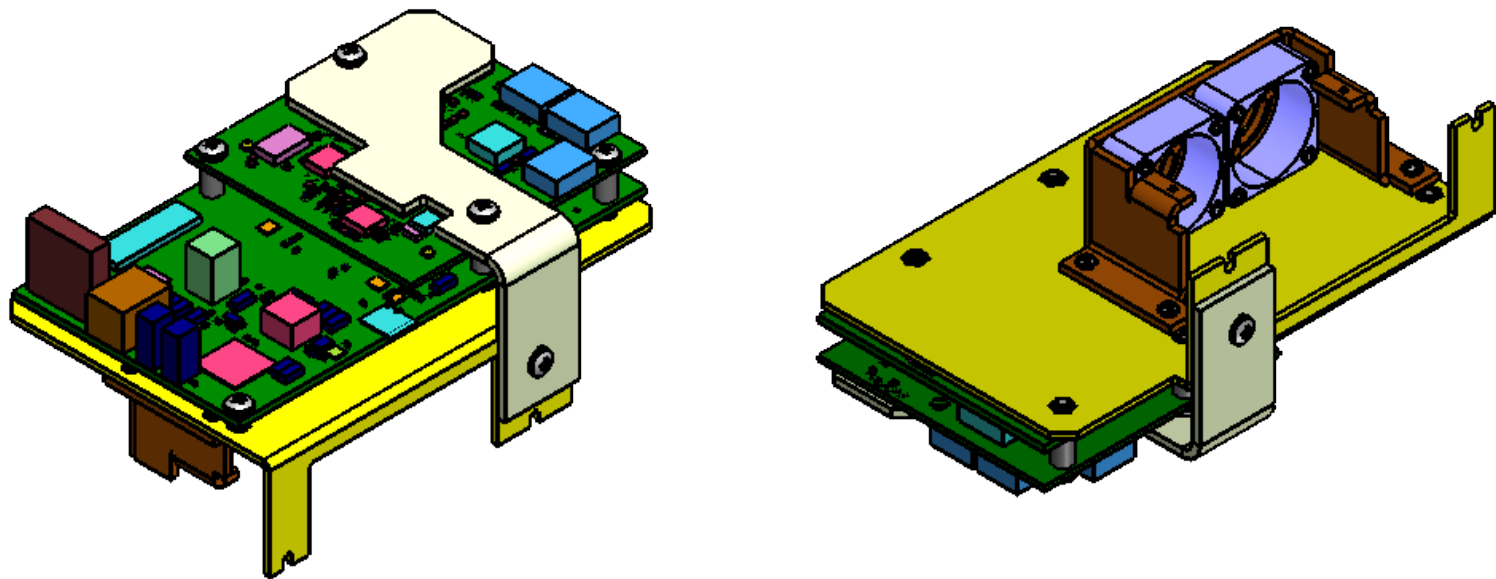
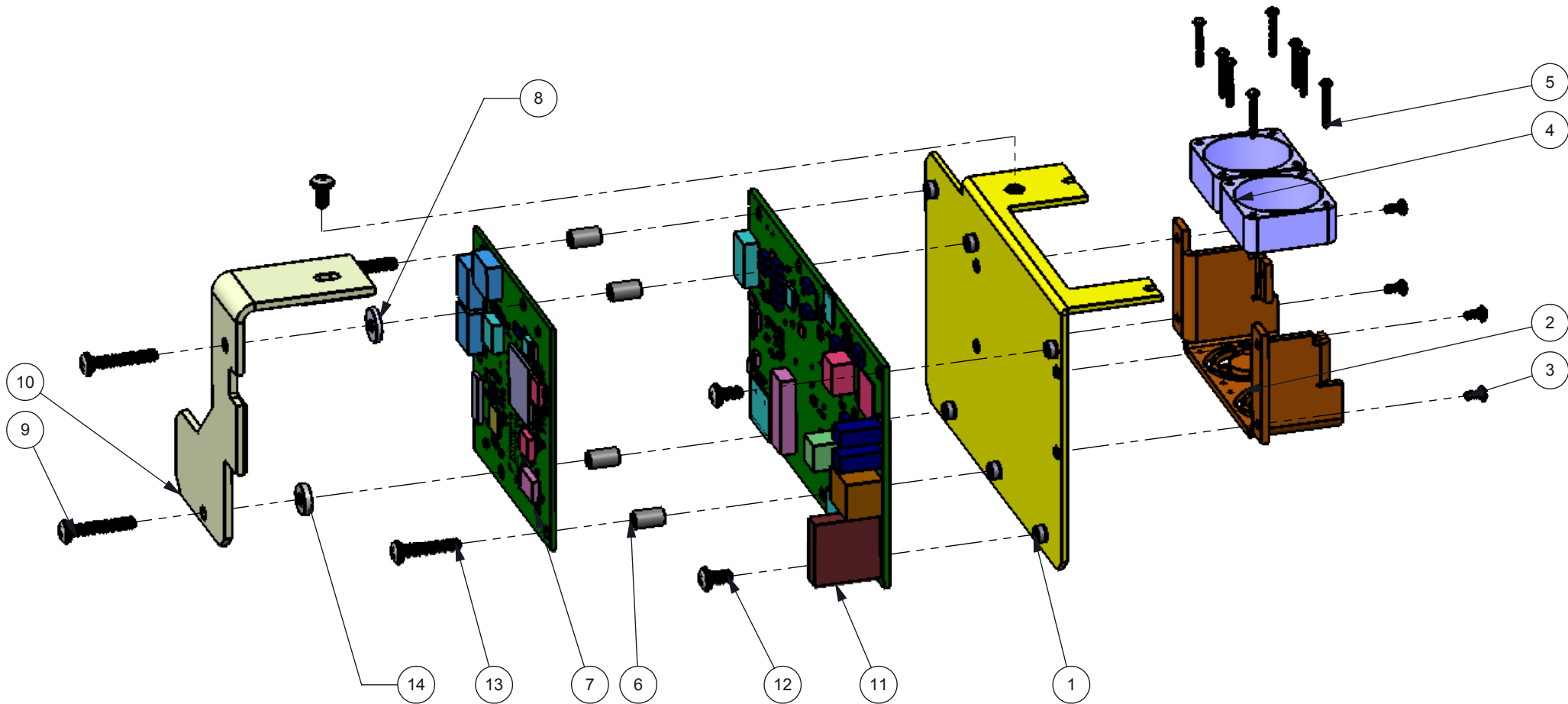

ITEM NO.	PART NUMBER	DESCRIPTION	QTY.
1	3010-EVM-G2-MAIN-BOARD-MOUNT	3010 EVM PCB MOUNT	1
2	3010-EVM-G2-FAN-MOUNT-SS	FAN MOUNT	1
3	92000A011	M2 X 4MM LONG PAN HEAD (McMaster-Carr)	4
4	259-1557-ND	FAN, 25X10MM, 5VDC (DIGIKEY)	2
5	92000A007	M1.6 X 12MM LONG PAN HEAD (McMaster-Carr)	8
6	94669A103	4.5 X 8MM LONG SPACER (McMaster-Carr)	4
7	DLPDLCR3010EVM-G2_DisplayBoard	3010 DISPLAY BOARD	1
8	032030011407-ND	WASHER, FLAT, M3 PLASTIC (Digi-Key)	1
9	92005A127	M3 X 18MM LONG PAN HEAD (McMaster-Carr)	2
10	3010-EVM-G2-PAD3000-HEATSINK-FLEX-BRACKET	PAD 3000 HEATSINK	1
11	DLPDLCR3010EVM-G2_MainBoard	3010 FORMATTER BOARD	1
12	92005A116	M3 X 6MM LONG PAN HEAD (McMaster-Carr)	3
13	92005A126	M3 X 16MM LONG PAN HEAD (McMaster-Carr)	2
14	93657A029	M3 NYLON SPACER (McMaster-Carr)	1

UNLESS OTHERWISE SPECIFIED

- DIMENSIONS ARE IN MILLIMETERS
- TOLERANCES: ANGLES $\pm 1^\circ$
2 PLACE DECIMALS ± 0.25
1 PLACE DECIMALS ± 0.50
- DIMENSIONAL LIMITS APPLY BEFORE PROCESSES
- INTERPRET DIMENSIONS IN ACCORDANCE WITH ASME Y14.5M-1994
- REMOVE ALL BURRS AND SHARP EDGES
- PARENTHETICAL INFO FOR REF ONLY

DWN STEVE SMITH	DATE 12/7/2016
Engr	
CQE/QA	
CM	
Apprvd	



3010 ELECTRONICS ASSEMBLY

SIZE	DWG NO	REV
B	3010-EVM-G2-ELECT-ASM	D

SCALE 1:5 SHEET 1 OF 1

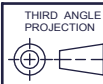

NEXT ASSY	USED ON
APPLICATION	